

ZONING PLAN GENERAL NOTES

- 1.) THIS PLAN REFERENCES DOCUMENTS AND INFORMATION BY:
 - A.) ALTA / NSPS LAND TITLE SURVEY PREPARED FOR: JOHNSON DEVELOPMENT ASSOCIATES, INC. PREPARED BY: CONTROL POINT ASSOCIATES, INC. DATED: 5-29-2019
- 2.) THIS CONCEPT WAS PREPARED STRICTLY BASED UPON INFORMATION IDENTIFIED ABOVE.
- 3.) THE CONCEPT REPRESENTED HEREIN IDENTIFIES A DESIGN CONCEPT RESULTING FROM LAYOUT PREFERENCES IDENTIFIED BY THE OWNER COUPLED WITH A PRELIMINARY REVIEW OF ZONING AND LAND DEVELOPMENT REQUIREMENTS AND ISSUES. THE FEASIBILITY WITH RESPECT TO OBTAINING LOCAL, COUNTY, STATE, AND OTHER APPLICABLE APPROVALS ARE NOT WARRANTED AND CAN ONLY BE ASSESSED AFTER FURTHER EXAMINATION AND VERIFICATION OF SAME REQUIREMENTS AND PROCUREMENT OF JURISDICTIONAL APPROVALS.
- 4.) THIS CONCEPT PLAN IS PREPARED FOR CONCEPTUAL PRESENTATION PURPOSES ONLY AND IS NOT INTENDED FOR UTILIZATION AS A ZONING AND/OR CONSTRUCTION DOCUMENT. THE EXISTING CONDITIONS SHOWN HEREON ARE BASED UPON INFORMATION THAT WAS SUPPLIED TO OUR OFFICE AT THE TIME OF PLAN PREPARATION AND MAY BE SUBJECT TO CHANGE AND MUST BE UPDATED UPON PERFORMANCE OF ADDITIONAL DUE DILIGENCE.

SITE CALCULATIONS

APN 30-00-14124-00-3 33,450 SF
 APN 30-00-14128-00-8 11,190 SF
 CONSOLIDATED BASE SITE AREA: 44,600 SF

CONSOLIDATED BASE SITE AREA: 44,600 SF
 EASTON ROAD ULT. R.O.W. 2,800 SF
 NET LOT AREA: 41,800 SF

ZONING

EXISTING ZONING: MS-H MAIN STREET HIGH INTENSITY / DENSITY
 PROPOSED USE: C-31 SELF-STORAGE FACILITY (PERMITTED BY-RIGHT)

FIGURE 10.18 MS-H DIMENSIONAL REQUIREMENTS (CLASS 2)

	REQUIRED	EXISTING	PROVIDED
DENSITY:			
LOT	n/a	n/a	n/a
MIN. LOT AREA:	30,000 SF	41,800 SF	41,800 SF
MIN. LOT WIDTH:	150.0 FEET	200.0 FEET	200.0 FEET
MIN. GREEN AREA:	35.0%	17.0% (7,119 SF) (ENC) *	36.4% (15,212 SF)
BUILDINGS ON THE SAME LOT:	n/a	n/a	n/a
MIN. BUILDING SEPARATION:	n/a	n/a	n/a
BUILDING SIZE:	n/a	100.0%	100.0%
THE LARGEST BUILDING ON LOT MUST HAVE AT LEAST 50% OF ITS FRONT FACADE LOCATED IN THE BUILD-TO-ZONE			
BUILD TO LINE			
MIN.:	15.0 FEET	11.5 FEET (ENC)	15.0 FEET
MAX.:	25.0 FEET	158.6 FEET (ENC)	15.0 FEET
MAX. DISTANCE FROM CURB WITH STREET WALL AND SHARED PARKING AND STREET ACCESS IN FRONT:			
	70.0 FEET	158.6 FEET (ENC) *	n/a (NO STREET WALL REQUIRED) *
SETBACKS			
MIN. SIDE YARD:	30.0 FEET	19.4 FEET (ENC); 0.0 FEET (ENC)	68.0 FEET; 15.0 FEET **
MIN. REAR YARD:	35.0 FEET	37.7 FEET (ENC)	37.0 FEET
BUILDING SETBACK FROM R1/R2/R3/R4 DISTRICTS:	55.0 FEET	n/a	n/a
TRASH STORAGE SETBACK FROM R1/R2/R3/R4 PROPERTIES:	20.0 FEET	n/a	n/a
BUILDING			
MAX. BUILDING FOOTPRINT:	n/a	n/a	n/a
MIN. FACADE HEIGHT:	20.0 FEET	12.5 FEET (ENC)	46.0 FEET
MAX. BUILDING HEIGHT:	35.0 FEET	35.0 FEET	46.0 FEET (R)
MIN. WINDOW AREA:	n/a	n/a	n/a
STREET-FACING FACADES			
GROUND FLOOR:	45.0%	T.B.D.	T.B.D. BY OTHERS
UPPER STORIES:	25.0%	T.B.D.	T.B.D. BY OTHERS
PARKING			
PARKING SETBACK FROM STREET WALL AND LANDSCAPING:	5.0 FEET (FROM COMBINATION OF STREET WALL & LANDSCAPING)	0.0 FEET (ENC) *	n/a (NO STREET WALL REQUIRED) *
MAX. WIDTH, PARKING BETWEEN PRINCIPAL BUILDING AND SIDE LOT LINE (FOR BUILDING IN BUILD-TO-ZONE):			
	70.0 FEET	n/a	68.0 FEET
MIN. PARKING SETBACK FROM ADJUTING R1/R2/R3/R4 PROPERTIES:	20.0 FEET	n/a	n/a
MIN. PARKING SETBACK FROM MS PROPERTIES AND DISTRICTS OTHER THAN R1/R2/R3/R4:	10.0 FEET, IF SHARED PARKING	n/a (NO SHARED PARKING)	n/a (NO SHARED PARKING)
MAX. WIDTH, STREET ACCESS POINT:	35.0 FEET	43.8 FEET (DRIVE AISLE WIDTH) (ENC)	24.0 FEET (DRIVE AISLE WIDTH)
SECTION 2103 USE C-31 REQUIREMENTS			
MAX. HEIGHT OF STORAGE UNIT:	12.0 FEET	n/a	11.33 FEET (1 ST FLOOR TO 2 ND FLOOR-GREATEST HEIGHT CHANGE)
SECTION 2304 PARKING REQUIREMENTS			
USE C-31:	1 SPACE FOR EVERY 100 UNITS, PLUS ONE SPACE PER EMPLOYEE ON THE LARGEST SHIFT (T.B.D. UNITS / 100 + T.B.D. EMPLOYEES = TOTAL)	n/a	9 SPACES (ALLOWS FOR 1 EMPLOYEE + 800 UNITS)
SECTION 2310 PARKING LOT FRONTAGE DEVELOPMENT STANDARDS			
MIN. PARKING SETBACK FROM BUILDING:	5.0 FEET	0.0 FEET (ENC)	6.0 FEET
MIN. PEDESTRIAN WALKWAY:	5.0 FEET	0.0 FEET (ENC)	6.0 FEET
MIN. PLANTING STRIP:	3.0 FEET	0.0 FEET (ENC)	17.3 FEET
SECTION 2312 (FIG. 23.2) LOADING REQUIREMENTS			
OTHER USES (AS DEEMED NECESSARY BY THE BOARD OF COMMISSIONERS):			
TOTAL LOADING:	0 BERTHS **	0 BERTHS (ENC)	0 BERTHS ***
SECTION 2403 B BUFFER REQUIREMENTS			
MIN. BUFFER WIDTH:	15.0 FEET (UNLESS OTHERWISE SPECIFIED)	0.0 FEET (ENC)	15.0 FEET
SECTION 2504 SIDEWALK AND CROSSWALKS			
PUBLIC STREETS:	8.0 FEET	6.3 FEET (ENC)	8.0 FEET
MAIN ACCESS DRIVES:	8.0 FEET	0.0 FEET (ENC)	8.0 FEET
(ENC) EXISTING NON-CONFORMITY (R) POTENTIAL RELIEF NEEDED			
NOTES			
* STREET WALL REQUIRED WHEN BUILDING IS MORE THAN 20.0 FEET FROM ULT. R.O.W.			
** SITING PARKING TO THE SIDE AND/OR REAR OF THE BUILDING. ONE BONUS POINT MAY BE ACHIEVED. ONE BONUS POINT ALLOWS FOR THE REDUCTION OF THE SIDE YARD FOR A CLASS II USE IN THE MS-H DISTRICT FROM 30.0 FEET DOWN TO 15.0 FEET.			
*** PENDING REVIEW BY BOARD OF COMMISSIONERS.			

LEGEND



LOCATION MAP
SCALE: 1"=50'

BOHLER ENGINEERING
 SITE CIVIL AND CONSULTING ENGINEERING
 LAND SURVEYING
 PROGRAM MANAGEMENT
 LANDSCAPE ARCHITECTURE
 SUSTAINABLE DESIGN
 PERMITTING SERVICES
 TRANSPORTATION SERVICES

REVISIONS

REV	DATE	COMMENT	DRAWN BY	CHECKED BY
1	2019.08.22	BUILDING REVISIONS	JMF	JPA

811
 Know what's below.
 Call before you dig.
 PENNSYLVANIA
 YOU MUST CALL 811 BEFORE ANY EXCAVATION WHETHER IT'S ON PRIVATE OR PUBLIC LAND
 1-800-242-1775

NOT APPROVED FOR CONSTRUCTION

THIS DRAWING IS INTENDED FOR MUNICIPAL AND/OR AGENCY REVIEW AND APPROVAL. IT IS NOT INTENDED AS A CONSTRUCTION DOCUMENT UNLESS PROTECTED OTHERWISE.

PROJECT: **ZONING PLAN**
 FOR: **JOHNSON DEVELOPMENT ASSOCIATES, INC.**
 PROPOSED STORAGE
 1538 EASTON ROAD
 ABINGTOWN TOWNSHIP
 MONTGOMERY COUNTY, PA

BOHLER ENGINEERING
 1600 MANOR DRIVE, SUITE 200
 CHALFONT, PA 18914
 Phone: (215) 996-9100
 Fax: (215) 996-9102
 www.BohlerEngineering.com

J.P. ALEJNKOVC
 PROFESSIONAL ENGINEER
 PENNSYLVANIA LICENSE NO. PE000400

SHEET TITLE: **ZONING PLAN**
 SHEET NUMBER: **1**
 REVISION 1 - 2019.08.22

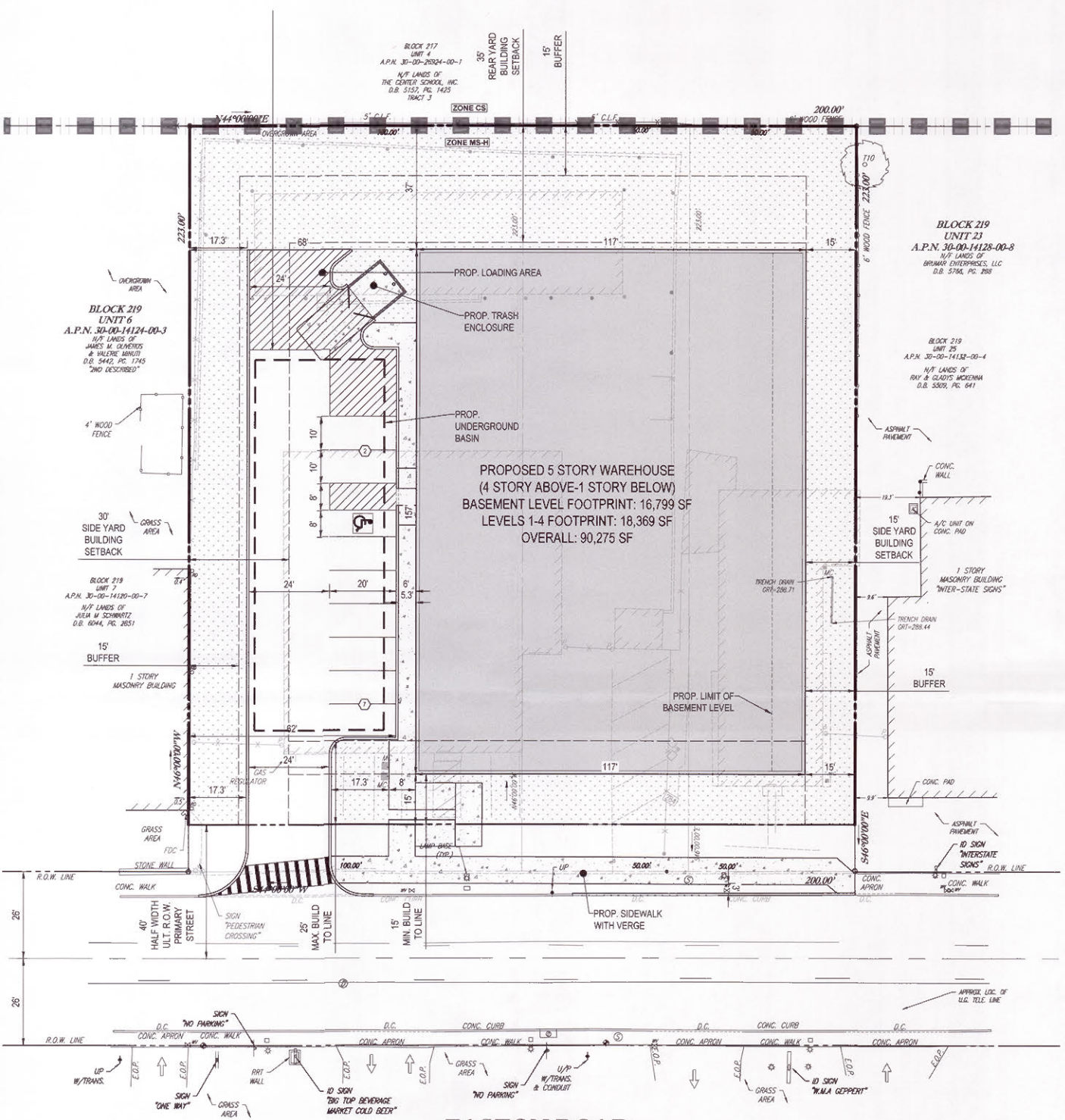

EASTON ROAD

(52' WIDE R.O.W. - PER D.B. 5442, PG. 1745)
 TWO WAY TRAFFIC (ASPHALT ROADWAY)

RELIEF REQUESTED

1. A VARIANCE FROM FIGURE 10.18 OF THE ZONING ORDINANCE TO PERMIT A BUILDING HEIGHT OF 46.0 FEET IN LIEU OF THE REQUIRED MAXIMUM BUILDING HEIGHT OF 35.0 FEET.
2. AN INTERPRETATION THAT LOADING SPACES ARE NOT REQUIRED ON THE SUBJECT PROPERTY PURSUANT TO SECTION 2312 AND FIGURE 23.2 OF THE ZONING ORDINANCE OR, IN THE ALTERNATIVE, A VARIANCE FROM SECTION 2312 AND FIGURE 23.2 OF THE ZONING ORDINANCE TO NOT PROVIDE VEHICLE LOADING SPACES ON THE SUBJECT PROPERTY.
3. A VARIANCE FROM SECTION 2403 D OF THE ZONING ORDINANCE TO PERMIT 0.0% FOUNDATION PLANT MATERIAL WHERE 25% OF THE LINEAR AREA BETWEEN THE FOUNDATION AND SIDEWALKS, ACCESS DRIVES, OR PARKING AREAS SHALL BE LANDSCAPED WITH ORNAMENTAL OR EVERGREEN TREES AND SHRUBS.



R:\1919\PC191199\2019\ZONING\PLAN SETS\ZONING\REVISION 1\PC191199.ZONING-1.LAYOUT.1.ZONING